

# Stratum™ Weatherboards

## Technical Supplement

### Vertical installation



**STRATUM™**  
WEATHERBOARDS



The original intention of Innova™ Stratum™ range of weatherboards was to install them horizontally as prescribed in the current Innova™ Stratum™ Install Guide. This supplement covers the alternative installation of Innova™ Stratum™, Stratum™ Duo and Stratum™ Trio cladding in a 90 deg vertical orientation. This supplement must be read in conjunction with the current Innova™ Stratum™ Technical Brochure – [bgcinnoovadesign.com.au/facades-linings/innova/stratum/](http://bgcinnoovadesign.com.au/facades-linings/innova/stratum/)

#### Accessories available from BGC - Table 01

www.bgcinnoovadesign.com.au

INTERNAL ALUMINIUM CORNER	3000mm x 17mm	BGC PRODUCT CODE INTCNR17	
EXTERNAL ALUMINIUM CORNER	3000mm x 17mm	BGC PRODUCT CODE EXTCNR17	
SNAP ON CORNER A	3600mm x 45mm	BGC PRODUCT CODE SNAPCNR36A	
SNAP ON CORNER B	3600mm x 45mm	BGC PRODUCT CODE SNAPCNR36B	
CAVITY CLOSER	2700mm x 19mm	BGC PRODUCT CODE 480	
J MOULD	2700mm x 14mm	BGC PRODUCT CODE 805	
TIMBER DURABATTEN	2700mm x 70mm x 19mm	BGC PRODUCT CODE 490	
STEEL DURABATTEN	3000mm x 70mm x 19mm	BGC PRODUCT CODE 495	
EPDM FOAM GASKET	25m	BGC PRODUCT CODE 845	

# Stratum™ Weatherboards

## Technical Supplement

### Vertical Installation

#### Fasteners

2.5 x 45mm Flat Head Nail Class 3 Coil Nail



2 x 50mm ND Brad – Paslode ND Brad



2.87 x 50mm Cladfast Offset Round Head Nail



18 x 30mm Fibre Zip CSK screw



#### Stratum™ Weatherboard Coverage

Effective Cover per weatherboard 4200 x 276mm or 1.159m<sup>2</sup>/2700 x 276mm or 0.745m<sup>2</sup>

NO. OF PLANKS	1	2	3	4	5	6	7	8	9	10	11	12	13	14	15
WALL LENGTH mm	300	576	852	1128	1404	1680	1956	2232	2508	2784	3060	3336	3612	3888	4164

#### Coastal Areas

The durability of galvanised nails and screws used for exterior cladding in coastal or similar corrosive environments can be as low as 10 years.

For this reason BGC recommend the use of stainless steel fasteners within 1km of the coast or other large expanses of salt water.

#### Framing and Fastening

STRATUM™ VERTICAL OPTION 1 20mm Vertical Cavity Batten @ 270mm centres			
Wind Class as per AS4055-2012	STUD SPACING		FIXING NOTES
	Within 1200mm of corners	Elsewhere	
N1	600	600	Concealed fixing
N2	600	600	Concealed fixing
N3	N/A	N/A	
N4	N/A	N/A	
C1	N/A	N/A	

STRATUM™ VERTICAL OPTION 2 Direct to Frame - Additional Noggins @ max. 600mm centres			
Wind Class as per AS4055-2012	STUD SPACING		FIXING NOTES
	Within 1200mm of corners	Elsewhere	
N1	600	600	Concealed fixing
N2	600	600	Concealed fixing
N3	600	600	Concealed and face fixing
N4	450	450	Concealed and face fixing
C1	450	450	Concealed and face fixing

## Installation Guidelines

- Start with the leading underlap - the top of the weatherboard in the traditional orientation, facing in the direction you are cladding i.e If starting from the left, the underlap should be facing right.
- When starting from an internal corner or where the Stratum™ intersects with another type of cladding, the overlap should be removed to give a solid edge. If starting from an external corner this is not required as the Snap on Corner will cover the overlap.
- Apply a continuous bead of polyurethane sealant along the cleft of the overlap (A) to ensure the joint between the two planks is sealed. Additionally, apply a second bead of sealant along the face of the underlap (B).
- Face fix the weatherboard into the top and bottom plates. Then conceal fix at each fixing point (If using ND brads, weatherboards must always be face fixed and conceal fixed).
- Concealed fasteners must be max. 18mm from the edge of the underlap and min. 50mm from the corner of the weatherboard.
- ND Bradding method requires 3 brads per noggin or common fixing point – 1 concealed, 2 in the face.
- The weatherboards will need to be checked during installation for plumb and to ensure the shiplap fully engages with the adjacent board as the variation of how tight the weatherboards interlock can influence the variation in plumb.
- Use hand nailing, gun nail with Cladfast, coil nailers or ND Bradder. A full round flat head min. class 3 nail is required. Do not use 'D' head framing gun nails and do not overdrive below the face of the weatherboard.
- Stratum™ weatherboards should be discontinuous over floor junctions with a 'Z' flashing installed to separate the levels and allow any trapped moisture to escape.
- Thermal breaks will be required over all contact points between the cladding and the frame – Top plate, noggins, studs and bottom plate. EPDM foam can be used as a thermal break.
- Fixing to steel framing –
  1. 0.55 – 0.75 BMT use Class 3 18x30mm Fibre Zip
  2. 0.75 – 1.6 BMT use Class 3 32mm Quickdrive.

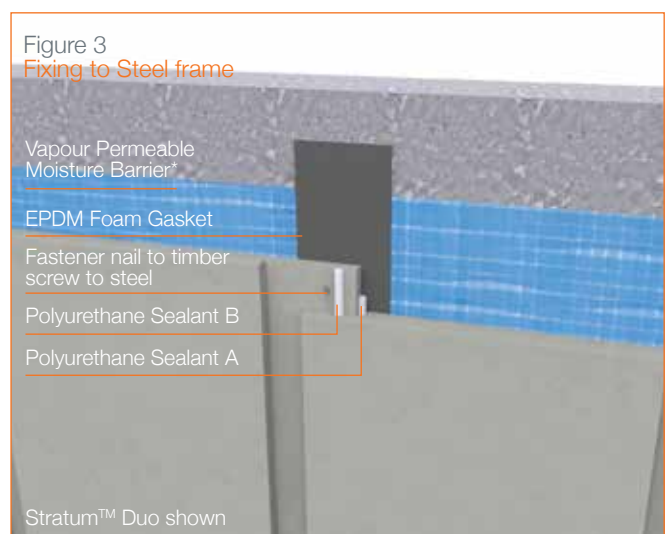
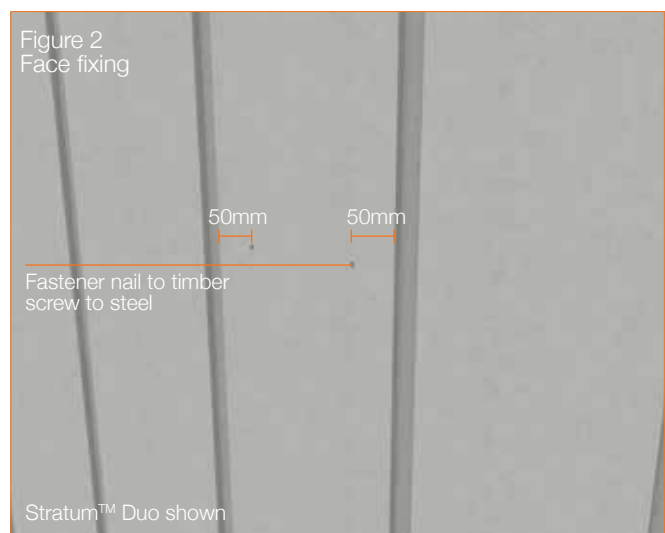
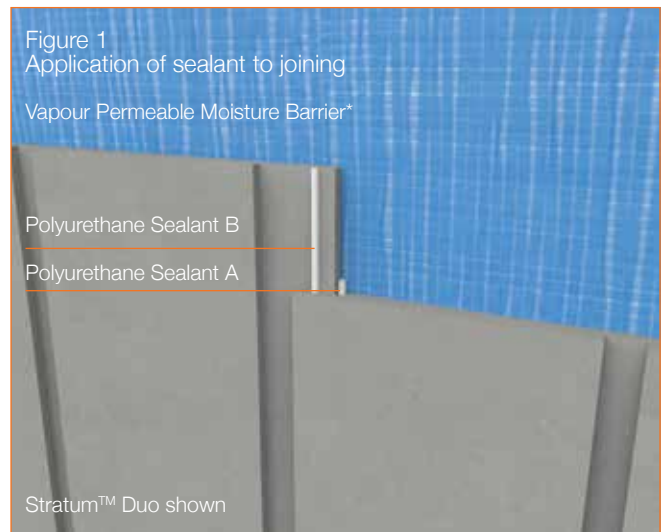

# Stratum™ Weatherboards

## Technical Supplement

### Vertical Installation

#### OPTION 1 - Fixed to 20mm Durabattens Suitable for Wind Classification N1 and N2 only

- Stud centres are to be spaced at max. 600mm centres.
- Install timber or steel Durabattens to align with weatherboard joints (270mm centres). Additional noggins will be required for timber Durabattens at max. 800mm centres. Fix Durabattens to top plate, noggins and bottom plate.
- Install a cavity closer at the bottom of the wall and at any vertical termination of the weatherboard i.e above window and doors to allow ventilation and to prevent vermin from entering the cavity.
- Stratum™ to be conceal fixed through the weatherboard underlap at max. 450mm centres.

#### OPTION 2 - Fixed off-stud to noggins Suitable for Wind Classification N1 to N4 & C1

- Stud centres are to be spaced max. 600mm centres.
- Additional noggins are to be provided at the following spacing:
  1. 600mm centres for Wind Classification N1 to N3
  2. 450mm centres for Wind Classification N4 and C1
- Stratum™ weatherboards may be conceal fixed to the noggins through the plank underlap or face fixed as follows:
  1. 1 concealed fixing or 2 brad nails at 150mm centres for N1 and N2
  2. 1 face fixing and 1 concealed fixing for N3, N4 and C1

#### Maintenance

Stratum™ when used in accordance with this literature requires no direct maintenance.

Annual inspections of the weatherboards should be carried out to guard against water penetrating the structure and damaging the framework. Check flashing, sealant joints and paint work. Flashing and sealants must continue to perform their design function.

Damaged weatherboards should be replaced as originally installed and paint should be maintained.